

Fitting Instructions

Suitable for door thicknesses of 40-50mm

- 1 Decide on left opening or right opening (see below).
- 2 Install escutcheons and handles as per drawing.
Note; Leave screws slightly loose.
- 3 Adjust position, to make sure the handles turn smoothly.

Left Handed Door

use left hand to open



Right Handed Door

use right hand to open



Plate Style Handle

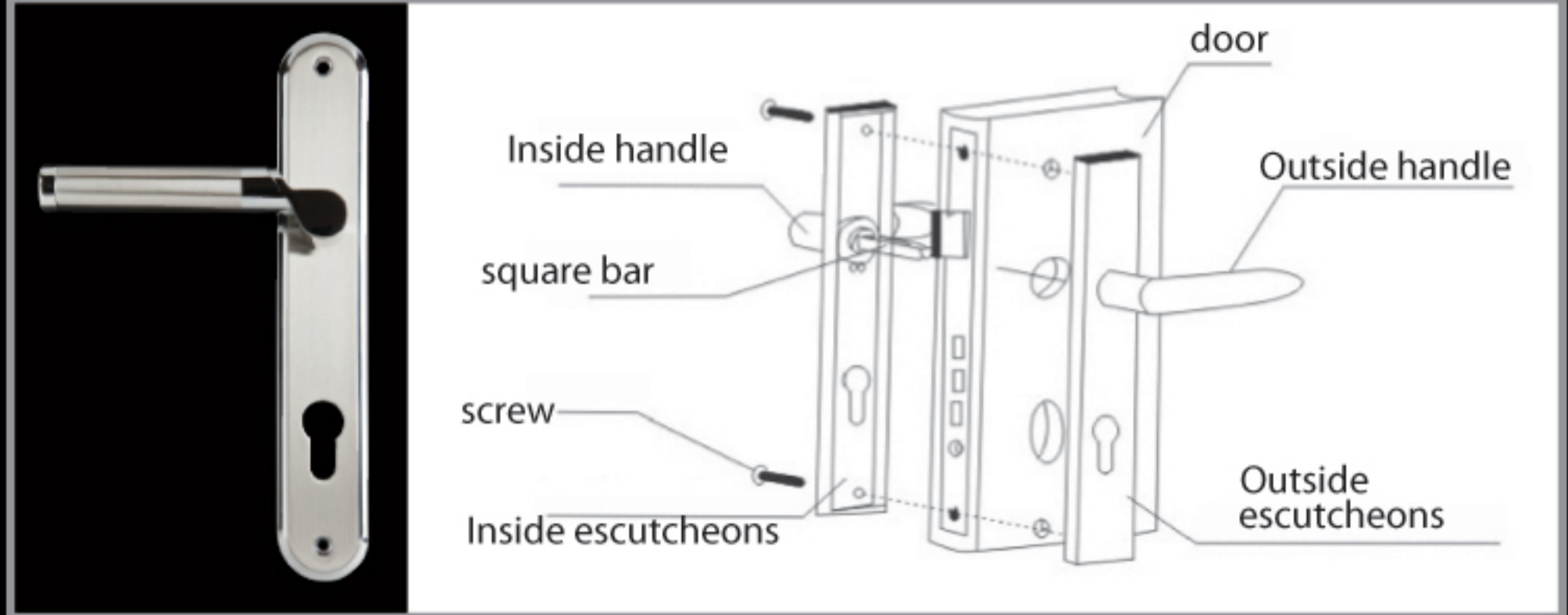

Rose Style Handle

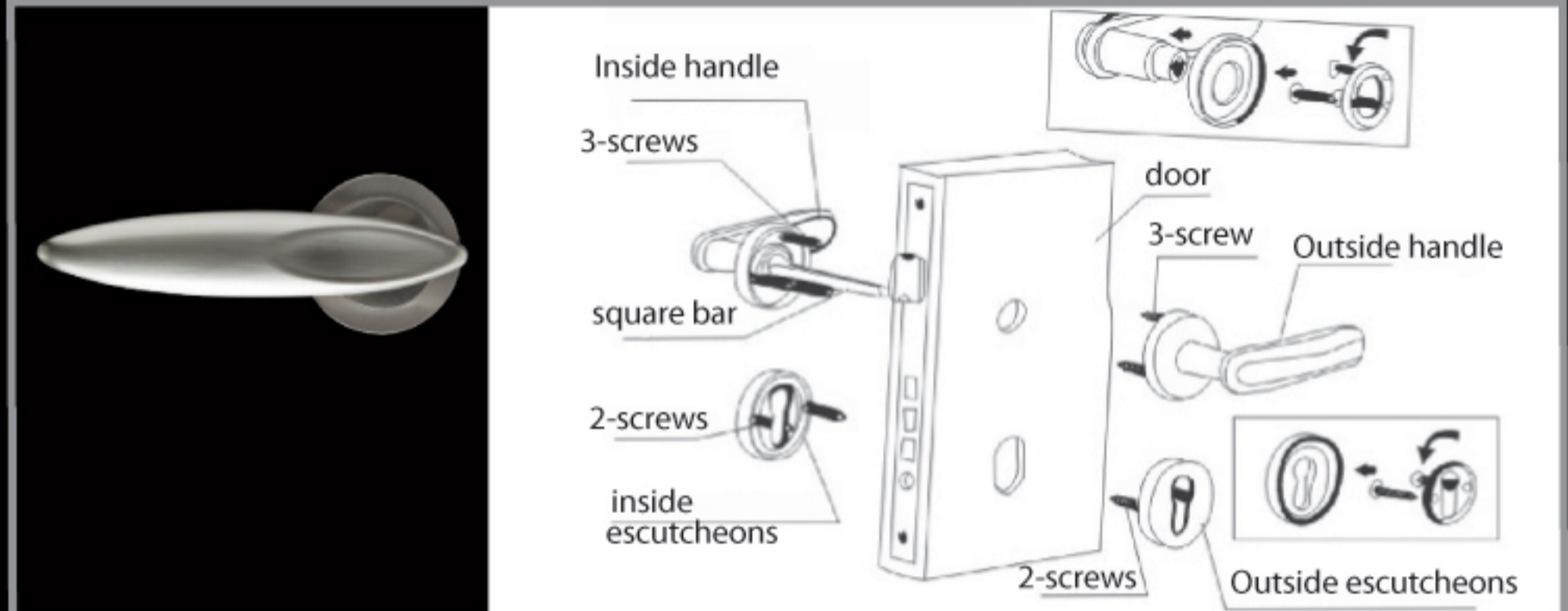

Cleaning Instructions

Always use a Soft cloth. If necessary, you can humidify the soft cloth. If absolutely necessary on rare occasions you can use a PH neutral soap on a soft cloth but immediately after application, you should remove any soap with the help of a moist soft cloth.

Under no circumstances should a hard tool (brush or wire metallic cloth), or an abrasive or acidic substance be used on the door handles.

Special Warning on Corrosive Air

Please be aware that environments where there are high concentrations of chemicals in the air, for example emanating from low quality paint or corrosive agents, Corrosion and damage may occur to the surface of the door lever. Door Levers should not be fitted into such environments until the high concentrations of chemicals in the air have subsided.